

# BMP0701F3NA2A

synchronous motor - BMP - 480 VAC - 0.37 kW  
- IP65 - IEC



## Main

Product or component type	Synchronous motor
Device short name	BMP
Maximum mechanical speed	3600 rpm
Nominal output power	370 W with drive ATV32 at 0.37 kW 400 V three phase 370 W with drive ATV320 at 0.37 kW 400 V three phase
Nominal torque	1.18 N.M with drive ATV32 at 0.37 kW 400 V three phase 1.18 N.m with drive ATV320 at 0.37 kW 400 V three phase
Nominal speed	3000 rpm with drive ATV32 at 0.37 kW 400 V three phase 3000 rpm with drive ATV320 at 0.37 kW 400 V three phase
Product compatibility	Variable speed drive ATV32 at 0.37 kW 400 V three phase Variable speed drive ATV320 at 0.37 kW 380...500 V three phase
Shaft end	Keyed
IP degree of protection	IP65 standard IP67 with IP67 kit
Holding brake	Without
Mounting support	International standard flange
Electrical connection	Rotatable right-angled connector

## Complementary

Range compatibility	Altivar Machine ATV320 Altivar 32
[Us] rated supply voltage	480 V
Network number of phases	Three phase
Maximum current Irms	2.3 A with drive ATV32 at 0.37 kW 400 V three phase 2.3 A with drive ATV320 at 0.37 kW 400 V three phase
Nominal operating frequency	250 Hz with drive ATV32 at 0.37 kW 400 V three phase 250 Hz with drive ATV320 at 0.37 kW 400 V three phase
Minimum operating frequency	60 Hz with drive ATV32 at 0.37 kW 400 V three phase 60 Hz with drive ATV320 at 0.37 kW 400 V three phase
Maximum operating frequency	300 Hz with drive ATV32 at 0.37 kW 400 V three phase 300 Hz with drive ATV320 at 0.37 kW 400 V three phase
Shaft diameter	11 mm
Shaft length	23 mm
Key width	4 mm
Motor flange size	70 mm
Torque constant	1.48 N.m/A at 40 °C
Number of motor poles	5
Number of motor stacks	1
Rotor inertia	0.59 kg.cm <sup>2</sup>
Stator resistance	17.75 Ohm at 40 °C
Stator inductance	40.03 mH for q-axis winding at 40 °C 40.03 mH for d-axis winding at 40 °C

Maximum radial force Fr	660 N at 1000 rpm 520 N at 2000 rpm 460 N at 3000 rpm 410 N at 4000 rpm
Maximum axial force Fa	0.2 x Fr
Type of cooling	Natural convection
Length	122 mm
Centring collar diameter	60 mm
Centring collar depth	2.5 mm
Number of mounting holes	4
Mounting holes diameter	5.5 mm
Circle diameter of the mounting holes	75...82 mm
Net weight	1.6 kg

## Packing Units

Unit Type of Package 1	PCE
Number of Units in Package 1	1
Package 1 Height	11.5 cm
Package 1 Width	19.0 cm
Package 1 Length	40.0 cm
Package 1 Weight	2.084 kg
Unit Type of Package 2	P06
Number of Units in Package 2	6
Package 2 Height	77.0 cm
Package 2 Width	80.0 cm
Package 2 Length	60.0 cm
Package 2 Weight	21.004 kg

## Offer Sustainability

REACH Regulation	 <a href="#">REACH Declaration</a>
EU RoHS Directive	Pro-active compliance (Product out of EU RoHS legal scope)
Mercury free	Yes
China RoHS Regulation	 <a href="#">China RoHS Declaration</a>
RoHS exemption information	 <a href="#">Yes</a>
WEEE	The product must be disposed on European Union markets following specific waste collection and never end up in rubbish bins
PVC free	Yes

## Contractual warranty

Warranty	18 months
----------	-----------

## Dimensions

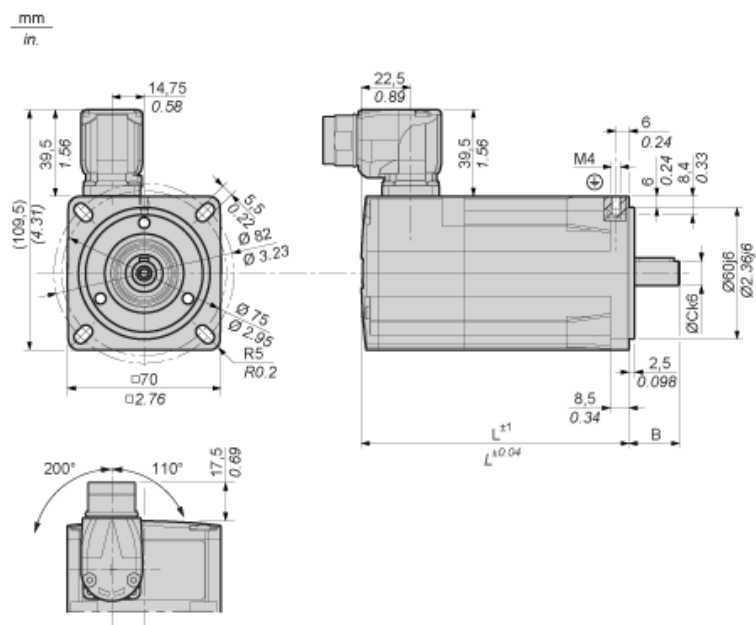

## Parallel Key According to DIN 6885 A

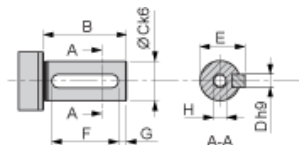

## Female Thread of Shaft According to DIN 332-D

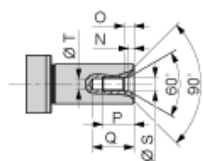

L	mm	122
in.	4.80	
B	mm	23
in.	0.90	
C	mm	11
in.	0.43	
D	mm	4
in.	0.16	
E	mm	12.5
in.	0.49	
F	mm	18
in.	0.71	
G	mm	2.5
in.	0.10	

H		M4
N	mm	2.1
in.	0.08	
O	mm	3.2
in.	0.12	
P	mm	10
in.	0.39	
Q	mm	14
in.	0.55	
S	mm	4.3
in.	0.17	
T	mm	3.3
in.	0.13	

### Performance curves

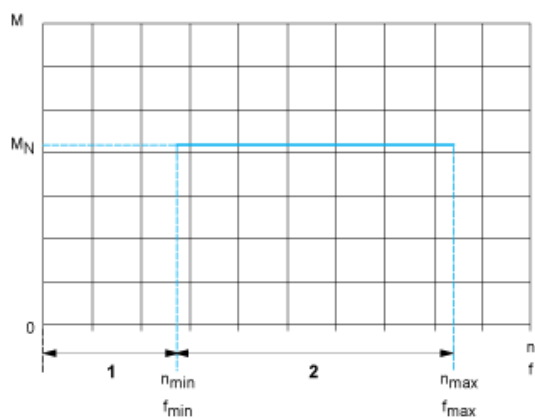

- $M$  : Torque in Nm  
 $n$  : Speed in rpm  
 $f$  : frequency in Hz  
1 : Only permissible during acceleration and deceleration phases.  
2 : Continuous operation with the default values from the configuration file.