

# KTA0800LP4D1

Flat elbow, Canalis KTA, aluminium, 800A, 3L +N+PE, N1, 1 made to measure long branch, right angle

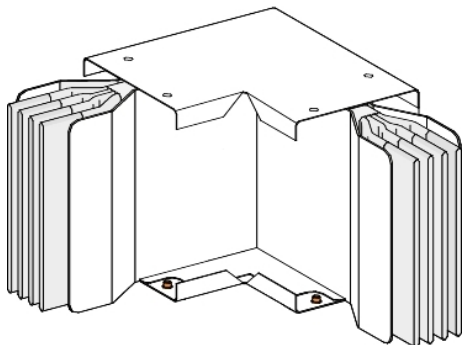

## Main

|                                |                               |
|--------------------------------|-------------------------------|
| Range                          | Canalis                       |
| Product name                   | KT                            |
| Product or component type      | Elbow                         |
| Busbar description             | Standard                      |
| Device short name              | KTA                           |
| Device application             | Change direction              |
| Material                       | Aluminium                     |
| [Ie] rated operational current | 800 A at 35 °C                |
| Polarity                       | 3L + N + PE                   |
| Direction change type          | Direction 1: flat to right    |
| Operating angle                | 90 °                          |
| Earth conductor                | Standard earth                |
| Short-circuit level            | Standard version              |
| Provided equipment             | Trunking unit<br>Joining unit |

## Complementary

|  |  |
|--|--|
| Housing material                         | Polyester film   |
| Contacts material                        | Copper   |
| [Ue] rated operational voltage           | 1000 V   |
| Network frequency                        | 50/60 Hz   |
| [Ui] rated insulation voltage            | 1000 V   |
| [Icw] rated short-time withstand current | 31 kA  |
| [Ipk] rated peak withstand current       | 64 kA  |
| Radiated magnetic field                  | 0.4 µT   |
| Thermal stress limit                     | 961000 kA².s   |
| THDI                                     | 0...15 % 800 A<br>15...33 % 1000 A<br>33...100 % 1250 A  |
| Maximum voltage drop                     | <0.0083 V with power factor = 1 at 50 Hz with 1A for 100 m long<br><0.0081 V with power factor = 0.9 at 50 Hz with 1A for 100 m long<br><0.0076 V with power factor = 0.8 at 50 Hz with 1A for 100 m long<br><0.0069 V with power factor = 0.7 at 50 Hz with 1A for 100 m long |
| Neutral position                         | Right  |
| Standards                                | IEC 61439-1<br>IEC 61439-6   |
| Dimension type                           | Made to measure long branch  |
| Width                                    | 140 mm   |
| Height                                   | 74 mm  |
| Length                                   | Direction 1: 300 mm<br>Direction 2: 800...1000 mm  |
| Colour                                   | White (RAL 9001)   |
| Linear load                              | 13 kg/m  |





## Environment

|                         |   |
|-------------------------|---|
| IP degree of protection | IP55 conforming to IEC 60529  |
| IK degree of protection | IK08 conforming to IEC 62262  |
| Derating factor         | 0...35 °C (100 % of In)<br>35...40 °C (97 % of In)<br>40...45 °C (93 % of In)<br>45...50 °C (90 % of In)<br>50...55 °C (86 % of In) |

## Packing Units

|                              |           |
|------------------------------|-----------|
| Unit Type of Package 1       | PCE       |
| Number of Units in Package 1 | 1         |
| Package 1 Height             | 7.4 cm    |
| Package 1 Width              | 35.0 cm   |
| Package 1 Length             | 105.0 cm  |
| Package 1 Weight             | 17.745 kg |

## Offer Sustainability

|                            |   |
|----------------------------|---|
| EU RoHS Directive          | Compliant with Exemptions   |
| Mercury free               | Yes   |
| China RoHS Regulation      |  <a href="#">China RoHS Declaration</a>        |
| RoHS exemption information |  <a href="#">Yes</a>                           |
| Environmental Disclosure   |  <a href="#">Product Environmental Profile</a> |
| Circularity Profile        |  <a href="#">End Of Life Information</a>     |
| WEEE                       | The product must be disposed on European Union markets following specific waste collection and never end up in rubbish bins     |