

Product data sheet

Characteristics

ZB4FBZ014

Metal Ring, Harmony XB4, Liquid spray protective washer, for flush mounted, grey, 30mm, NEMA hole



Main

Range of product	Harmony XB4
Accessory / separate part designation	Liquid spray protective washer for insertion beneath head
Accessory / separate part type	Washer
Accessory / separate part category	Protection accessories
Product compatibility	ZB4F
Accessory / separate part destination	XB4F
Colour	Chromium plated

Complementary

Sale per indivisible quantity	10
Environmental characteristic	High pressure cleaner

Environment

IP degree of protection	IP66 conforming to IEC 60529 IP67 conforming to IEC 60529 IP69 conforming to IEC 60529 IP69K conforming to ISO 20653 Type 13 conforming to UL 50 E Type 12 conforming to UL 50 E Type 4 conforming to UL 50 E Type 4X conforming to UL 50 E
-------------------------	--

Packing Units

Unit Type of Package 1	PCE
Number of Units in Package 1	1
Package 1 Height	0.4 cm
Package 1 Width	4.4 cm
Package 1 Length	4.4 cm
Package 1 Weight	14.0 g
Unit Type of Package 2	CAR
Number of Units in Package 2	10
Package 2 Height	8.8 cm
Package 2 Width	4.6 cm
Package 2 Length	5.2 cm
Package 2 Weight	150.0 g

Offer Sustainability

REACH Regulation	REACH Declaration
EU RoHS Directive	Pro-active compliance (Product out of EU RoHS legal scope)
Mercury free	Yes
China RoHS Regulation	China RoHS Declaration
RoHS exemption information	Yes

Dimensions

mm
in.

ZB4FA●●
ZB4FV●●
ZB4FW●●

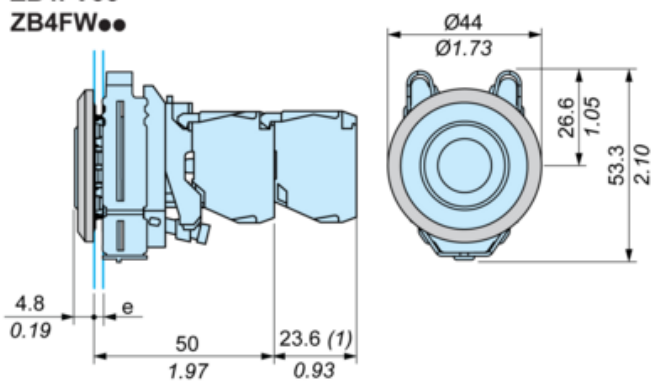

ZB4FJ●●

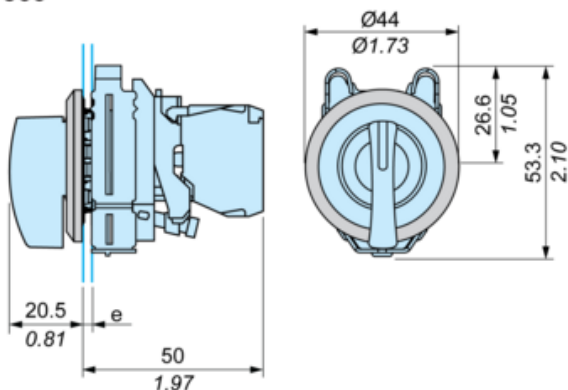

ZB4FL●●

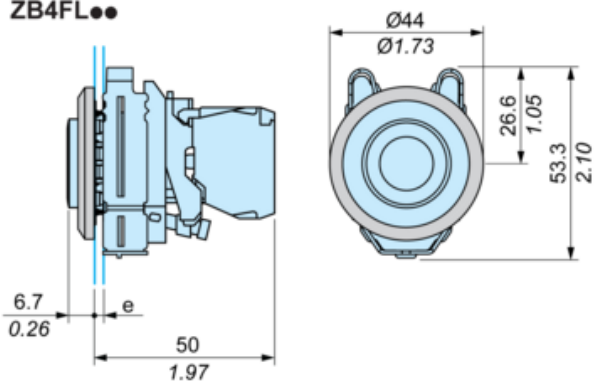

ZB4FG●●

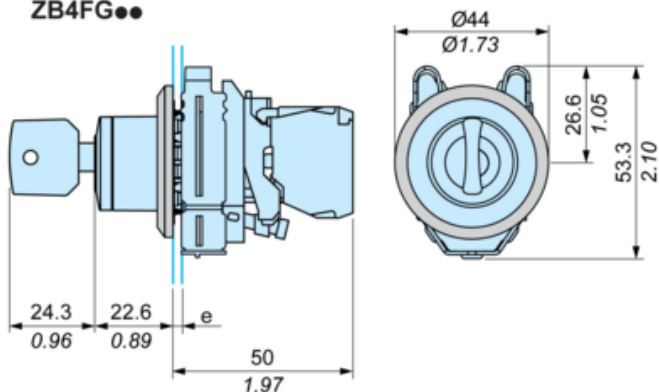

ZB4FD●●
ZB4FK●●

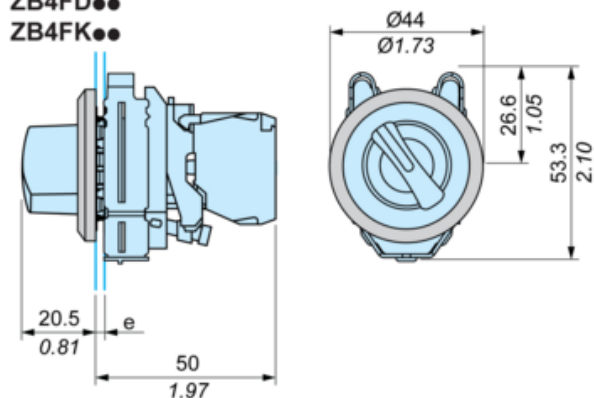

ZB4FD●9

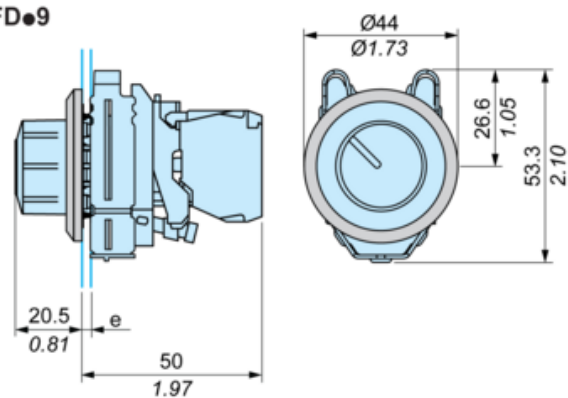

e : clamping thickness: 1 to 4.35 mm / 0.04 to 0.17 in.

(1) Additional row of contacts

Panel Cut-out for Pushbuttons, Switches and Pilot Lights (Finished Holes, Ready for Installation)

For use on flat surface of a type 4, type 4X, type 12, and type 13 enclosure

mm
in.

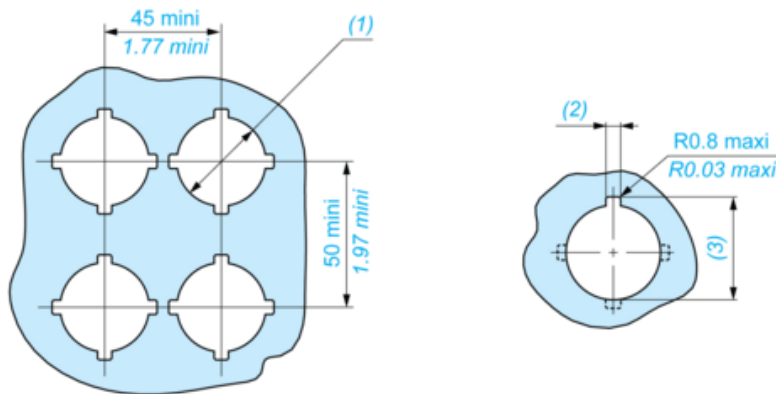

(1) $\varnothing 30.75 \text{ mm} \pm 0.25$ recommended ($\varnothing 30.5 \text{ mm}_0^{+0.5}$) / $\varnothing 1.21 \text{ in.} \pm 0.0098$ recommended ($\varnothing 1.21 \text{ in.}_0^{+0.0196}$)

(2) $4.90 \text{ mm} \pm 0.1$ recommended ($4.80 \text{ mm}_0^{+0.2}$) / $0.19 \text{ in.} \pm 0.0039$ recommended ($0.1889 \text{ in.}_0^{+0.0078}$)

(3) $33.25 \text{ mm} \pm 0.25$ recommended ($33 \text{ mm}_0^{+0.5}$) / $1.31 \text{ in.} \pm 0.0098$ recommended ($1.30 \text{ in.}_0^{+0.0196}$)